

# ACRYLIC ART HANGING INSTRUCTION

## RECOMMENDED TOOLS

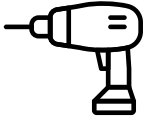

Drill

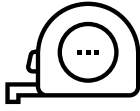

Tape Measure



Hammer

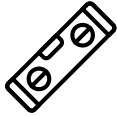

Level



Pencil

## HARDWARE SUPPLIED



Blue Anchor



Screws

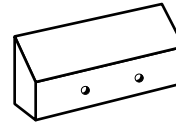

French Cleat\*

\*One mounted on Art, one loose for hanging

## MOUNT ART TO DRYWALL SURFACE AS FOLLOWS

\*Line should be 3 1/2" below the top of the artwork

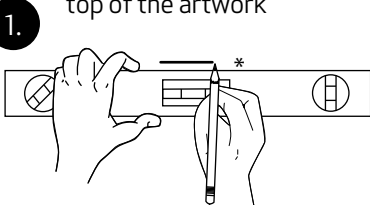

1. Mark a straight line against the wall

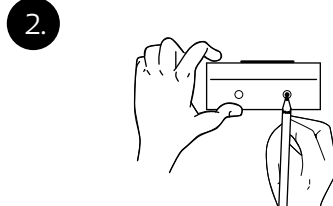

2. Hold the loose cleat against the line and mark the two hole locations

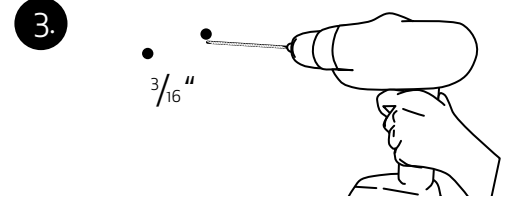

3. Drill into pilot hole marks on drywall

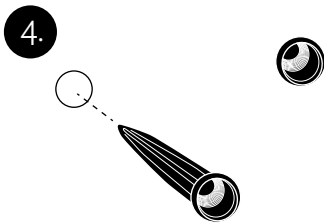

4. Hammer anchors into drilled holes until flush with the wall

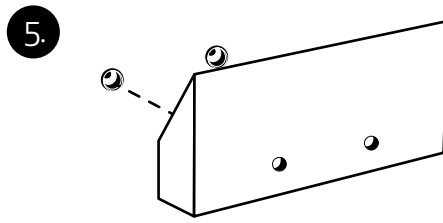

5. Align the loose cleat against the mounted anchors

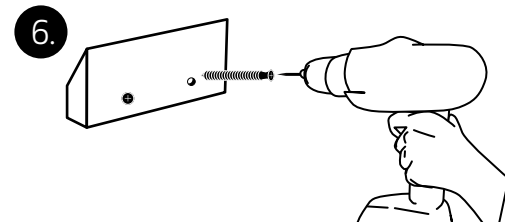

6. Drill screws through the holes on the cleat and into the anchors in the wall

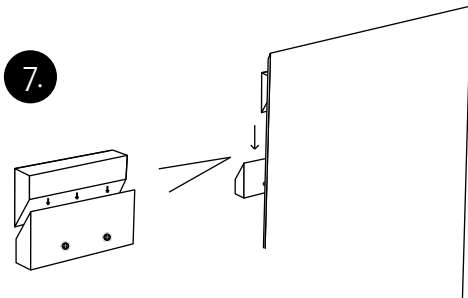

7. Hold the artwork against the wall above the wall cleat, and slide down to interlock the two cleats

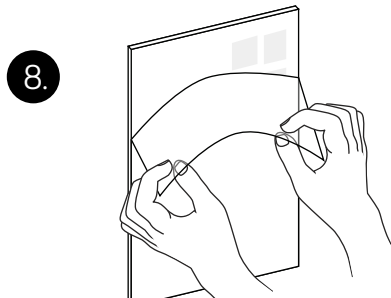

8. Peel protectant film off from acrylic print

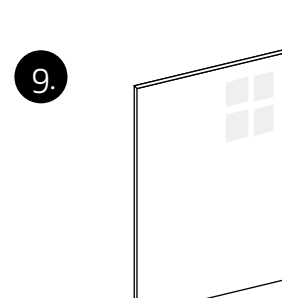

9. Enjoy your artwork!